

7 Ferncliffe North Road, Bristol, BS8 3NQ

[www.hydes.co.uk](http://www.hydes.co.uk)



## 7 Ferncliffe North Road, Bristol, BS8 3NQ

OFFERS ARE INVITED BETWEEN £325,000 & £350,000. A beautifully presented two bedroom, first floor apartment that forms part of this stunning detached Victorian property, set in a quiet and peaceful location in the ever popular area of Leigh Woods. The flat offers the rare benefit having lift access coupled with allocated off street parking for one car. Located within easy walking distance of Clifton Village via Brunel's world famous Clifton Suspension bridge the flat has recently undergone a program of neutral redecoration and re carpeting. It should be noted this property is being sold with no onward chain and can therefore be available to those seeking immediate occupation.



2



1



1

OFFERS ARE INVITED BETWEEN £325,000 & £350,000. A beautifully presented two bedroom, first floor apartment that forms part of this stunning detached Victorian property, set in a quiet and peaceful location in the ever popular area of Leigh Woods. The flat offers the rare benefit having lift access coupled with allocated off street parking for one car. Located within easy walking distance of Clifton Village via Brunel's world famous Clifton Suspension bridge the flat has recently undergone a program of neutral redecoration and re carpeting. It should be noted this property is being sold with no onward chain and can therefore be available to those seeking immediate occupation.



Approx. Gross internal Area  
665.0 Sq.Ft - 61.80 Sq.M

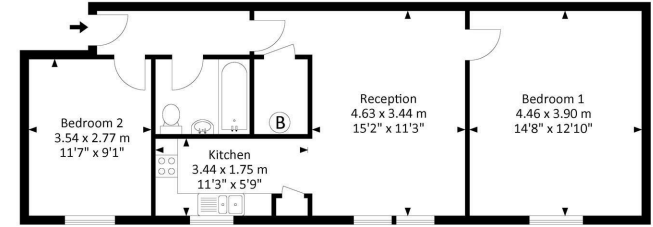

For illustrative purposes only. Not to scale.  
Whilst every attempt has been made to ensure accuracy of the floor plan all measurements are approximate and no responsibility is taken for any error, omission or measurement.  
Floor plan produced by Westcountry EPC.

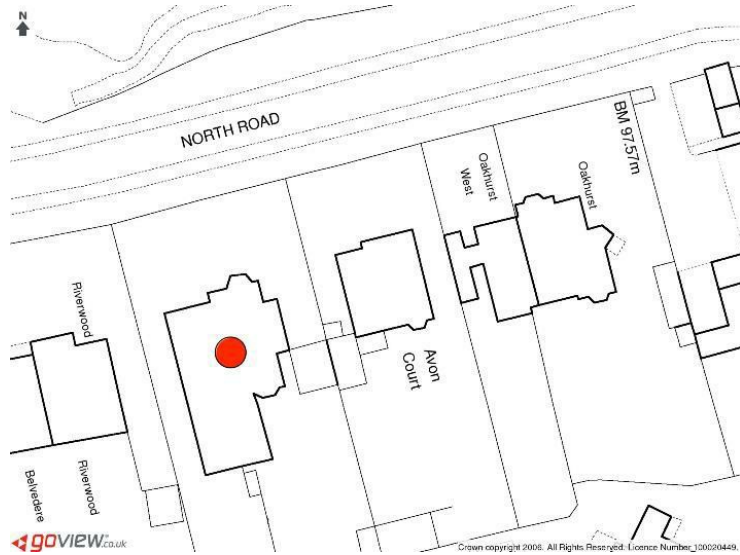

GOVIEW.co.uk

Crown copyright 2008. All Rights Reserved. Licence Number: 100020449.





Energy Efficiency Rating		Current	Potential
Very energy efficient - lower running costs			
(92 plus) A			
(81-91) B			
(69-80) C			
(55-68) D			
(39-54) E			
(21-38) F			
(1-20) G			
Not energy efficient - higher running costs			
England & Wales		EU Directive 2002/91/EC	

Environmental Impact (CO <sub>2</sub> ) Rating		Current	Potential
Very environmentally friendly - lower CO <sub>2</sub> emissions			
(92 plus) A			
(81-91) B			
(69-80) C			
(55-68) D			
(39-54) E			
(21-38) F			
(1-20) G			
Not environmentally friendly - higher CO <sub>2</sub> emissions			
England & Wales		EU Directive 2002/91/EC	

**OTHER INFORMATION**



28 Princess Victoria Street, Bristol, BS8 4BU  
 Tel: 0117 973 1516  
 post@hydes.co.uk | www.hydes.co.uk

**IMPORTANT NOTE**

Hydes Of Bristol and any joint agents give notice that (i) they have no authority to make or give representations or warranties in relation to the property. These particulars do not form part of any offer or contract and must not be relied upon as statements or representations of fact. (ii) Any areas, distances or measurements are approximate. The text, photographs and plans are for guidance only and are not necessarily comprehensive. It should not be assumed that the property has all the necessary planning, building regulations or other consents and Hydes Of Bristol have not tested any services, equipment or facilities. Purchasers must satisfy themselves by inspection or otherwise. (iii) In accordance with the consumer protection from unfair trading regulations, please note that the working condition of these services, or kitchen appliances has not been checked by the Agents but at the time of taking particulars we were informed that all were in working order. Please also note that current government legislation demands that as selling agents for this property, Hydes Of Bristol require written evidence of the origin/source of finance for funding for any prospective purchaser wishing to purchase this property. This confirmation shall be required prior to the vendor entering into any contract of sale and our instructions from the vendor are to this effect.